



BULUPOL-3

DOUBLE DISC GRINDER / POLISHER



BMS Bulut Makina Sanayi Ve Ticaret Ltd. Şti.

İkitelli Organize Sanayi Bölgesi Dolapdere Sanayi Sitesi

Ada 4 No : 7-9 Başakşehir / İSTANBUL-TURKEY

Phone : +90 212 671 02 24 / 671 02 25 Fax : +90 212 671 02 26

web : www.bulutmak.com e-mail : bms@bulutmak.com

Description	3
Technical Specifications	3
Standart Accessories	3
Unpacking	7
Installation.....	7
Plumbing	7
Electrical.....	7
How To Start Grinding & Polishing.....	7
Recommendations For Smooth Operation	7
Part List.....	9

Description

Grinding and polishing machine with 200 mm dia double disc
(250 mm also available on request)
Corrosion resistant GRP cover
Easy to change emery paper and polishing cloth
Long life V belted drive
Easy to adjust variable disc speed
Double side turning

Technical Specifications

Dimensions of machine	70(width)x63(deep)x40(height) cm
Case dimensions	79(width)x75(deep)x49(height) cm
Weight (net/gross)	50 / 90 kg
Motor	0,55 KW
Wheel speed	100 - 500 rpm (adjustable)
Mains	220 Volt, 50 Hz
Disc dia.	200 mm (250 mm on request)
Adjusting disc turning and water spraying time	✓
Manual & automatic water spray	✓

Standart Accessories

200 mm aluminium top discs and magnets
(2 pcs), stainless steel discs (5 pcs), flexible water hose and control valves, flexible water hose for drain connection.
Self adhesive emery paper (220 grit) 10 pcs
Self adhesive emery paper (400 grit) 10 pcs
Self adhesive emery paper (600 grit) 10 pcs
Self adhesive emery paper (800 grit) 10 pcs
Self adhesive polishing cloth 10 pcs
Diamond paste (3-6 microns)
Alumina suspension (500 gr)







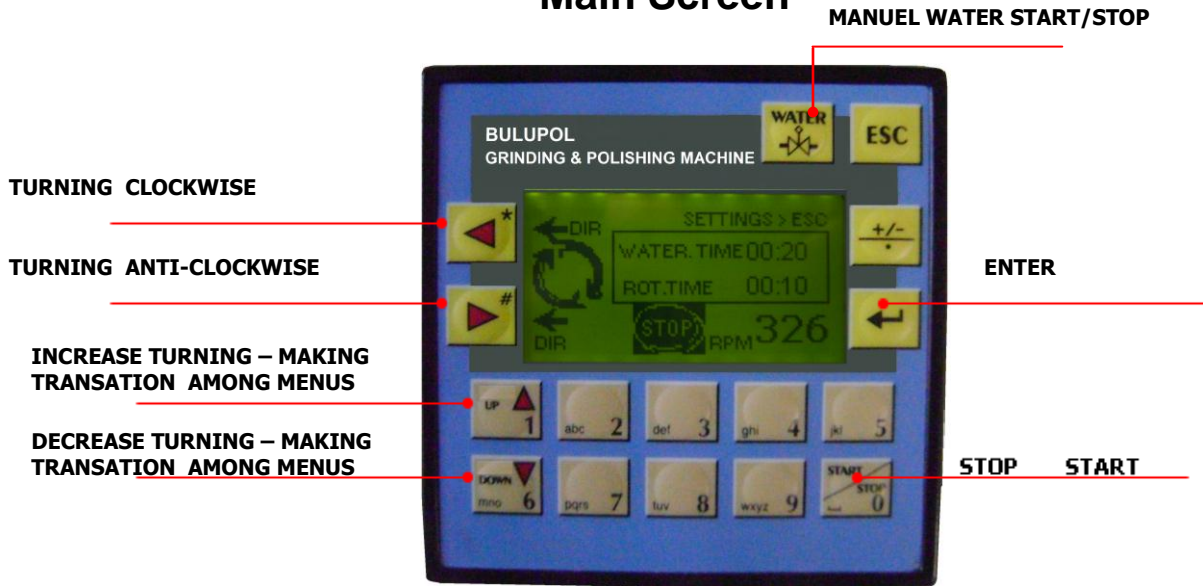







Main Screen



Functions Of Buttons On Panel

	START / STOP
	MANUEL WATER START/STOP (MAIN SCREEN)
	PARAMETER INPUTS
	ENT KEY (BUTTONS FOR CONFIRMING VALUE INPUTS)
	CANCELING VALUE INPUTS
	CLOCKWISE – MAKING TRANSITION AMONG MENUS
	ANTI-CLOCKWISE – MAKING TRANSITION AMONG MENUS
	EMERGENCY BUTTON
	INCREASE TURNING SPEED
	DECREASE TURNING SPEED



Working Parameters

ON MAIN SCREEN ENTERING WORKING PARAMETERS PUSHING MENU BUTTONS

1) ROTATION TIME	ENTERING TIMING (MINUTE) VALUES
2) WATER TIME	ENTERING TIMING (MINUTE) VALUES
3 ROTATION DIRECTION	SELECTION OF MOTOR DIRECTION BY RIGHT& LEFT ARROW

Unpacking

Remove packing materials and lift out the machine complete with baseboard. Remove 4 securing bolts that securs machine to the baseboard.

Installation

BULUPOL-3 grinder&polisher is shipped fully assembled , water valve,top discs,splash ring for emery paper , cloth

Plumbing

Water connection:

One end of 9 mm water hose is connected at rear of machine .Insert other end of to water source.

Drain connection:

Insert one end of 30,5 mm hose to washbowl located at left side of machine.An other end to drain.

Electrical

The unit can be plugged into existing outlet to electrical source rated 220V, 50HZ. **Earth connection also must be properly done.** When plugged machine is ready to operate.

How To Start Grinding & Polishing

Take out splash ring and locate suitable self adhesive emery paper with stainless steel disc on magnet of left top disc.

Place self adhesive polishing cloth with stainless steel disc on magnet of right top disc and Press start-stop button and adjust the speed using speed adjustment knob (**see control panel**)

Recommendations For Smooth Operation

- Use always splash ring te prevent accidental contact of fingers with rotating discs.
- Make sure that discs surfaces are clean and free from any residue from previous operation.Adhesive residue may be removed with approved slovents.

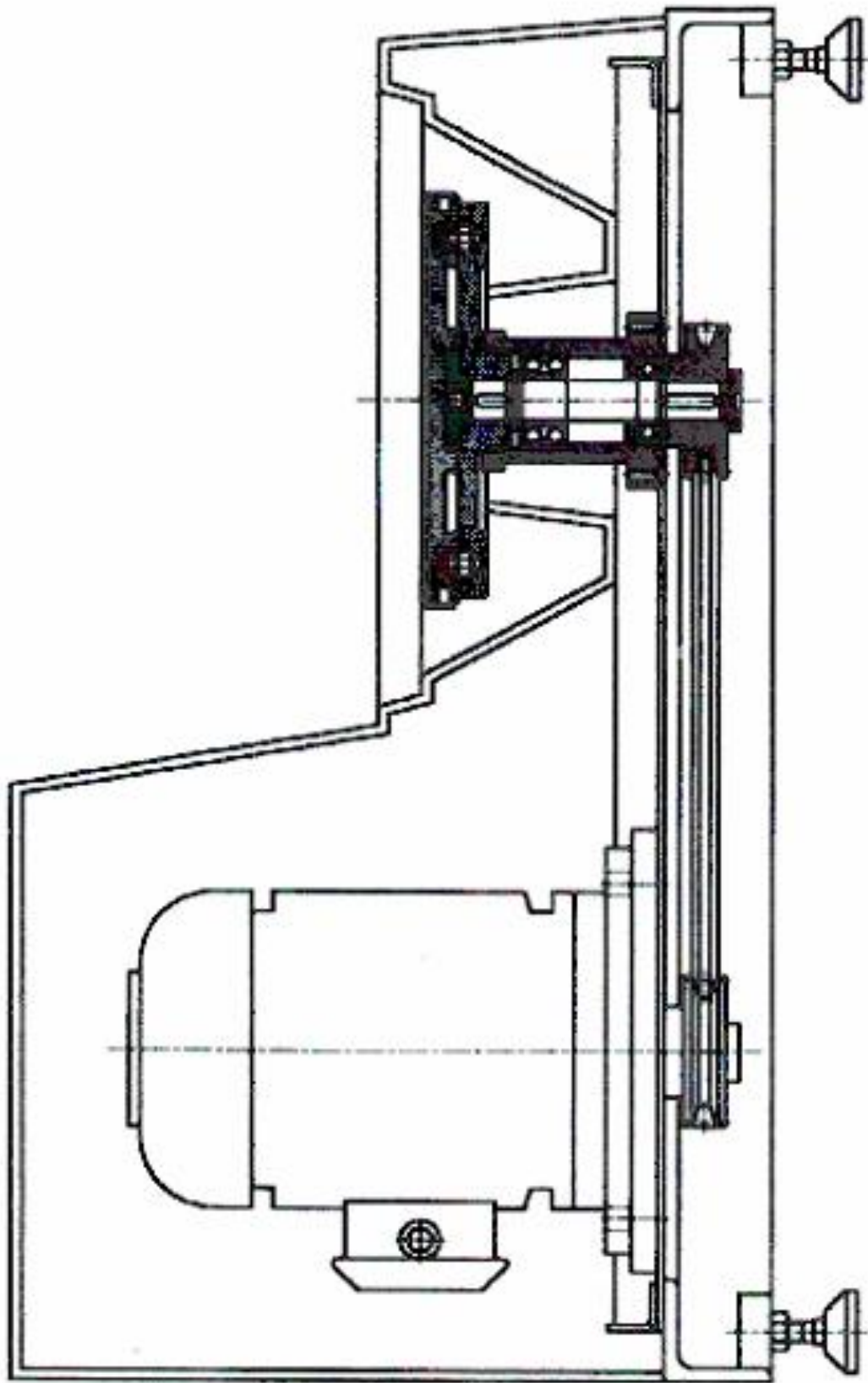

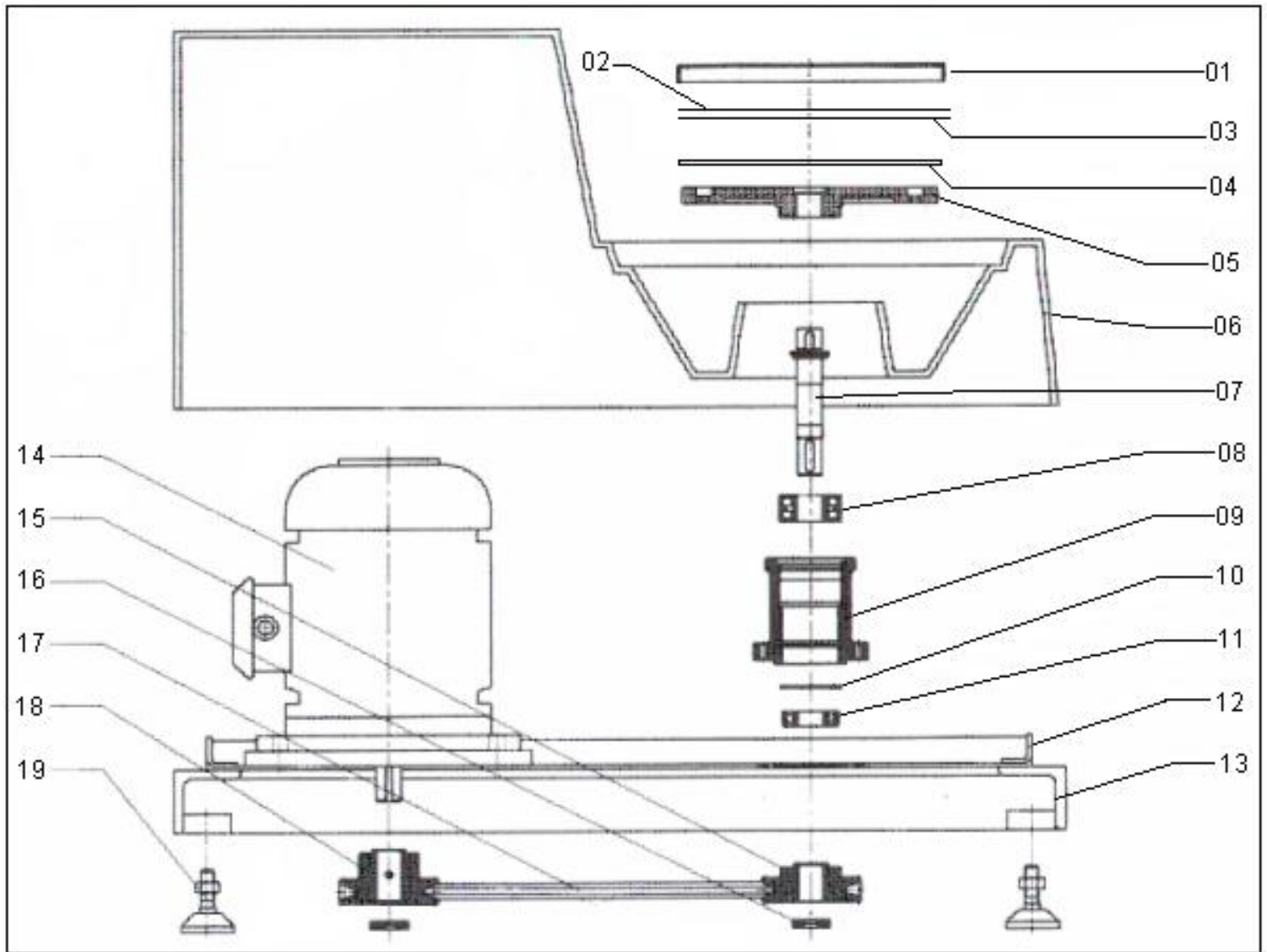

Part List

Part Nr.	Part Name	Part Nr.	Part name
1	Spash ring for emery paper	11	Bearing 3204-2RS
2	Self adhesive emery paper/ polishing cloth	12	Housing steel sheet plate
3	Stainless steel sheet disc	13	Aluminium base plate
4	Magnet	14	Motor
5	Top disc	15	V pulley
6	GRP cover	16	Fixing plate
7	Rotating spindle	17	V belt
8	Bearing 3204-2RS	18	V pulley
9	Housing for bearings	19	Levelling bolt
10	Washer		